

FIG. 9— CENTER MAIN BEARING

Item	Description	Part No.
1	Housing, Bearing (Less Bearing) Includes Items 3, 4, 5, 6, 7, 8 & 9	364-29050
2	Bearing, Center Main*	029-13494
3	Casting, Upper Half	009-00873
4	Casting, Lower Half	009-00874
5	Bushing, Tapered (2 Req'd.)	064-00320
6	Screw, Cap. 1/2 x 13UNC2A x 3-1/2 Lg.	021-01598
7	Bolt, Bearing (4 Req'd.)	064-00321
8	Nut, Flexloc (5 Req'd.)	021-13257
9	Washer, Plain (10 Req'd.)	021-05155
10	Pin, Dowel	064-32853
11	Plug, Pipe 3/8 NPTE	023-01983
12	Plug, Pipe w/ #5 Orifice	064-29216

*Part No. given is only one half of the bearing. Two pieces must be ordered to get a complete bearing.

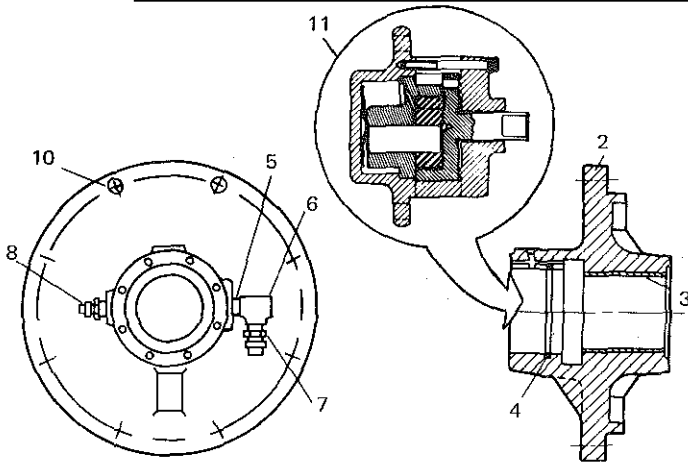
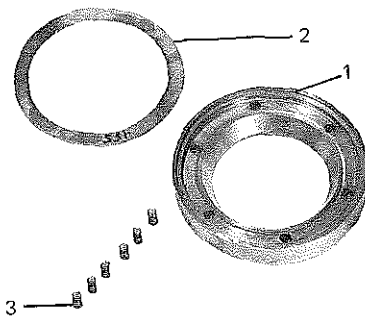

FIG. 10— BEARING HEAD AND OIL PUMP ASSEMBLY

Item	Description	Part No.
1	Head, Brg. Pump End (Complete Assem.— Includes Items 2, 4, 5, 6, 7 & 8)	364-31541
2	Head, Brg. Pump End (Bare)	064-28842
3	Bearing, Pump End	029-14059
4	Seal, "O" Ring 3-1/4 I.D. x 1/16	028-08729
5	Nip. Pipe 1/2 Sch 40 x 2-1/2 Lg.	070-01298
6	Tee, Screw 1/2 NPTI x 1/2 NPTI x 3/4 NPTI	023-04359
7	Connr., FLA 3/4 O.D. x 3/4 NPTE	023-10166
8	Connr., FLA 1/2 O.D. x 3/8 NPTE	023-09675
9	Gasket, Bearing Head	064-27289
10	Screw, Bearing Head (8 per Compr.)	021-02751
11	Pump, Oil Assembly	364-05894
12	Gasket, Oil Pump	064-20109
13	Screw, Cap Oil Pump (8 per Pump)	021-01425



Item	Description	Part No.
1	Plate, Valve Alone Ammonia Halocarbon	064-32799 064-31535
2	Valve, Suction	064-21897
3	Spring, Helical (6)	029-13813

FIG. 11— SUCTION VALVE PLATE

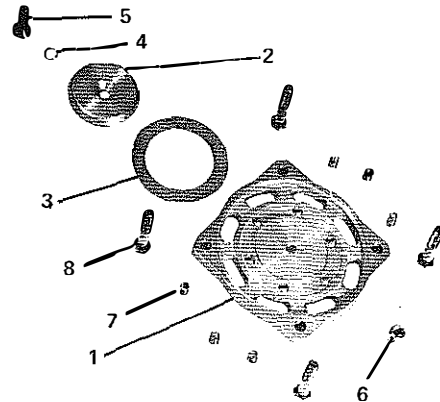

Item	Description	Part No.
1	Cage, Disch. Valve Ammonia Halocarbon	064-32800 064-28854
2	Plate, Disch. Valve	064-21754
3	Valve, Disch.	064-21898
4	Gasket	028-08386
5	Scr., Inner Disch.	021-13856
6	Nut, Self Locking	021-09932
7	Spring, Helical	029-13248
8	Screw, Cap 3/8 x 2-1/2 Lg. (4 per Valve)	021-10037

FIG. 12— DISCHARGE VALVE CAGE