

Item No.	Description	Part No.
1	Piston Ass'y. (includes Items 1 - 5)	
	SS42C, SS62C	365-24141
	SS63C	365-25148
	Piston, Bare	
	SS42C, SS62C	065-23812
2	Ring, Plain	029-03525
	Ring, Oil	029-06182
3	Pin, Piston	029-13884
4	Ring, Retaining (2 Req'd.)	029-13764
5	Connecting Rod Ass'y.	365-00374
6	Bolt	065-24373
7	Washer	021-01262
8	Nut	021-09610

FIG. 4 - PISTON AND CONNECTING ROD

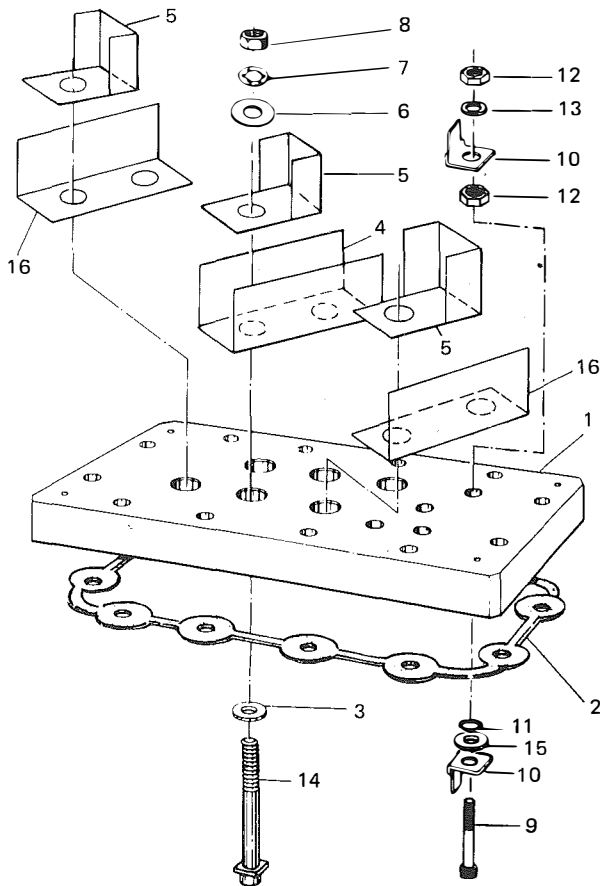

Item No.	Description	Part No.
1	Block, Terminal (Phenolic)	025-18426
2	Gasket, Terminal Block	070-15282
3	Gasket, Terminal Bolt	064-36152
4	Spacer, Insulating (1 Req'd.)	065-23627
5	Spacer, Insulating (3 Req'd.)	065-23626
6	Washer, Flat	021-05165
7	Lockwasher, Spring	021-08276
8	Nut, Hex	021-08581
9	Screw, Overload Protector	021-14619
10	Terminal	025-18650
11	Seal "O" Ring	028-09347
12	Nut, Hex	021-09991
13	Lockwasher	021-01133
14	Terminal Bolt, Motor	021-14493-001
15	Washer, Plain 3/16 I.D.	021-01240
16	Spacer, Insulating (2 Req'd.)	065-24385

FIG. 5 - MOTOR TERMINAL BLOCK (PHENOLIC TERMINAL BLOCK)