

Installation | 8778A Quick Disconnects

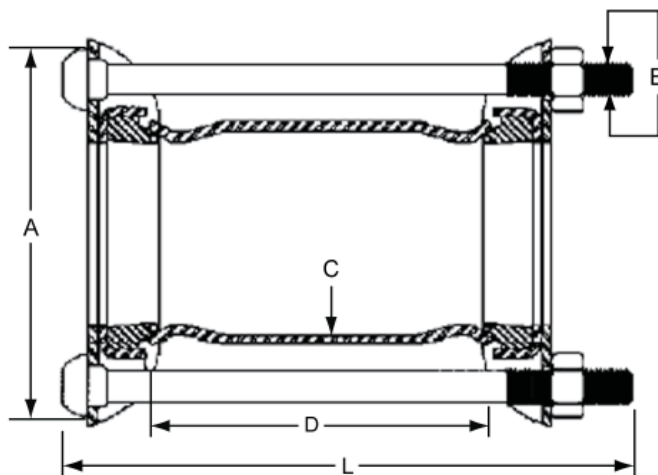

Part Number	Pipe		Follower	Sleeve		Bolts			Weight (Lbs.)
	Size	O.D.		"C"	"D"	"B"	"L"	No.	
8778A-01	1/2"	0.840	3 3/8	0.120	7.0	0.5	9.0	2	3.00
8778A-0	3/4"	1.050	3 15/16	0.120	7.0	0.5	9.0	2	3.00
8778A-1	1"	1.315	4 1/2	0.120	7.0	0.5	9.0	2	4.00
8778A-2	1 1/4"	1.660	4 5/8	0.120	7.0	0.5	9.0	2	5.00
8778A-3	1 1/2"	1.900	4 7/8	0.120	7.0	0.5	9.0	2	5.50
8778A-4	2"	2.375	6 3/4	0.156	7.0	0.6	11.0	3	8.00
8778A-6	3"	3.500	7 1/2	0.156	7.0	0.6	11.0	3	15.00
8778A-7	4"	4.500	8 1/2	0.188	7.0	0.6	11.0	3	17.00

8778A INSTALLATION INSTRUCTIONS

1. Pipe must be secured to prevent pipe pullout or movement.
2. Both pipe surfaces must be free and clean of any contaminants at a minimum distance equal to the overall length of the coupling. Pipe wrapping or coating pipe should be cut back a distance equal to the overall length of the coupling.
3. Pipe must be free of longitudinal gouges.
4. Apply soap to all gaskets and pipe to ensure proper lubrication during installation.
5. Insert the coupling between the two pieces of pipe, insure the coupling is centered and butt pipe ends together. (A small gap 1/16" maximum due to pipe not being square will not reduce coupling performance.)
6. Torque the nuts on the coupling assembly evenly to the following values:
 - 1/2" nuts- 30 Ft.lbs. MIN
 - 5/8" nuts- 80 Ft.lbs. MIN
7. Leak test prior to use.