

North American Series 1846A Three-Way, Two-Port Plug Valves

Sheet 1846A-1

1846A Three-Way, Two-Port Plug Valves (steam bronze) rated for 150 psi at 200 F and used to switch atomizing air and gas in 3 pipe dual-fuel burners, e.g., 6423, 6562, and 6565. Valve is furnished with wrench.

CAUTION

DO NOT LEAVE HANDLE IN INTERMEDIATE OR HALFWAY POSITION. ALWAYS USE A STANDARD GAS COCK ALONG WITH THE 1846A THREE-WAY VALVE TO PROVIDE POSITIVE SHUTOFF IN THE GAS LINE.

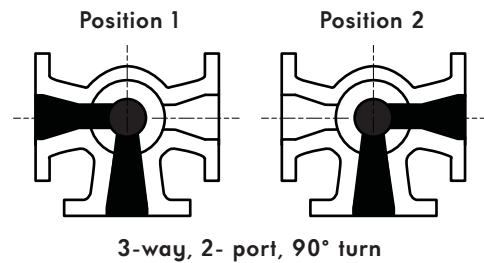
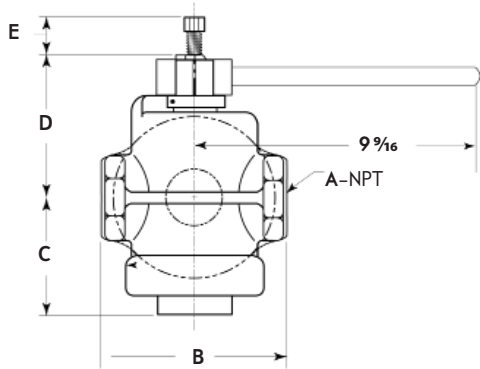
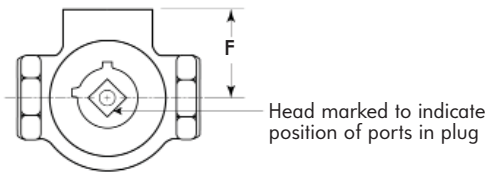

Valve designation	dimensions, inches						Equivalent length of pipe in ft	Working Pressure psi	Wt in lb
	A	B	C	D	E	F			
1846A-0	3/4	4 3/8	2 11/16	3 15/32	1 9/16	2 13/16	16.2	200	8
1846A-1	1	4 3/8	2 11/16	3 15/32	1 9/16	2 13/16	20.5	200	8
1846A-2	1 1/4	6	3 15/16	4 7/32	1 9/16	3	36.8	200	15
1846A-3	1 1/2	6	3 15/16	4 7/32	1 9/16	3	45.6	200	15
1846A-4	2	6 3/4	3 7/8	5 5/16	2 1/2	3 3/8	70	200	24 1/2

Note: For sizes -5 and -6 see Sheet 1846-1

DIMENSIONS SHOWN ARE SUBJECT TO CHANGE. PLEASE OBTAIN CERTIFIED PRINTS FROM FIVES NORTH AMERICAN COMBUSTION, INC. IF SPACE LIMITATIONS OR OTHER CONSIDERATIONS MAKE EXACT DIMENSION(S) CRITICAL.

WARNING: Situations dangerous to personnel and property may exist with the operation and maintenance of any combustion equipment. The presence of fuels, oxidants, hot and cold combustion products, hot surfaces, electrical power in control and ignition circuits, etc., are inherent with any combustion application. Components in combustion systems may exceed 160°F (71°C) surface temperatures and present hot surface contact hazard. Fives North American Combustion, Inc. suggests the use of combustion systems that are in compliance with all Safety Codes, Standards, Regulations and Directives; and care in operation.

CONTACT

fna.sales@fivesgroup.com
T +1 800 626 3477 - F +1 216 373 4237

Fives North American Combustion, Inc.
4455 East 71st Street - Cleveland, OH 44105 - USA
www.fivesgroup.com



fives
Industry can do it