



Diaphragm Air Motors Parts List

Parts List 1600-1

1600 Diaphragm Air Motor

PARTS ORDER MUST SPECIFY:

- 1 - Part Number
- 2 - Part Name
- 3 - For 1600 Air Motor

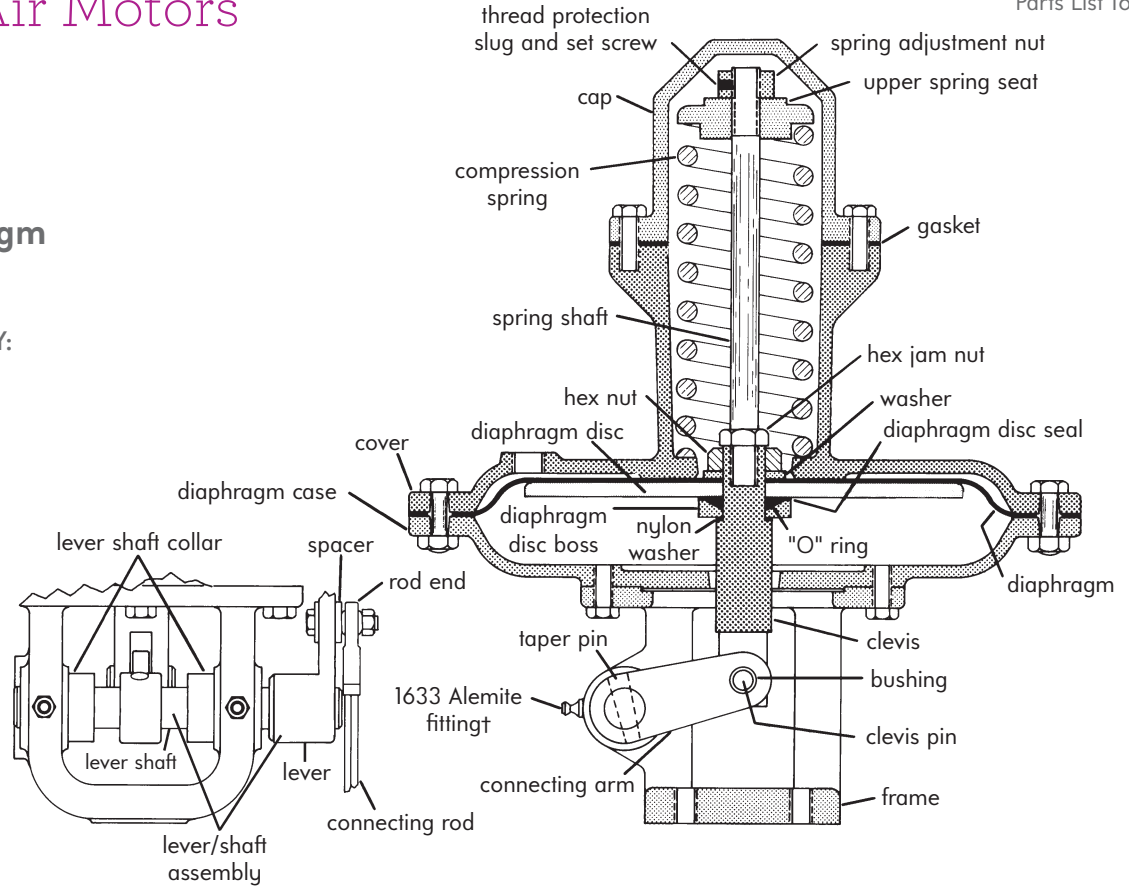

Part Name	Part No.	Part Name	Part No.	Part Name	Part No.
#1633 Alemite Fitting (2) †	R400-4180	Diaphragm Disc Seal	2-4249-1	Spacer	2-3342-3
Bushing	2-1982-1	Frame	2-1978-2	Set Screw	R776-2030
Cap	2-4775-1	Hex Jam Nut	R510-2340-JC	Spring Adj. Nut	2-2081-1
Clevis	2-4780-1	Hex Nut	R510-2420-JC	Spring Shaft	2-4781-1
Clevis Pin	2-1983-1	Lever/Shaft Assembly (all Valves other than Wafer)	2-9974-5	Taper Pin	R570-8602
Compression Spring	2-4779-1	Lever/Shaft Assembly (Wafer Valves only)	2-9974-6	Gasket	2-8869-1
Connecting Arm	2-1985-2	Lever (Automatic Burners)	11-5034-2	Thread Protection Slug	2-4657-1
Connecting Rod	See Below	Lever Shaft Collar (2) (Automatic Burners)	2-2200-1	Upper Spring Seat	2-1990-2
Cover	2-1976-4	Lever Shaft (Auto. Burners)	2-1991-3	Washer	R970-7450-C
Diaphragm	2-1979-1	Lever Shaft Collar (2) (Automatic Burners)	2-2200-1	Rod End (all Valves other than Wafer)	R030-9260
Diaphragm Case	2-1977-2	Nylon Washer	2-4782-1	Rod End (Wafer Valves only)	R030-9062
Diaphragm Disc	2-3644-1	"O" Ring	R520-4136		
Diaphragm Disc Boss	2-3643-4				

Connecting Rod Part No.	1008 Adjustable Port Valves	1004/14 Adjustable Port Valves	1126 Butterfly Valves
2-3069-9	-02, -01, -0, -1	B and C	-1, -2, -3, -4, -5, -6
2-3069-11	-2, -3, -4, -5, -6, -7, -8	D, E and F	-7, -8
2-3069-12	--	G	-9, -10
2-3069-13	--	--	-12, -14
2-3069-14	--	--	-16

† Any soda base grease of a No. 2 or medium hard consistency can be used. The ambient temperature range for a grease of this type is -40 to 250 F. The air motor should be re-greased at least once each month. Grease should be forced in until new grease appears outside the bearing ends. Even if the air motor is not used, grease should not be allowed to stay in the unit more than 48 months.