

Three non-catalog North American Standard Direct Drive Blowers

Sheet 2300-9

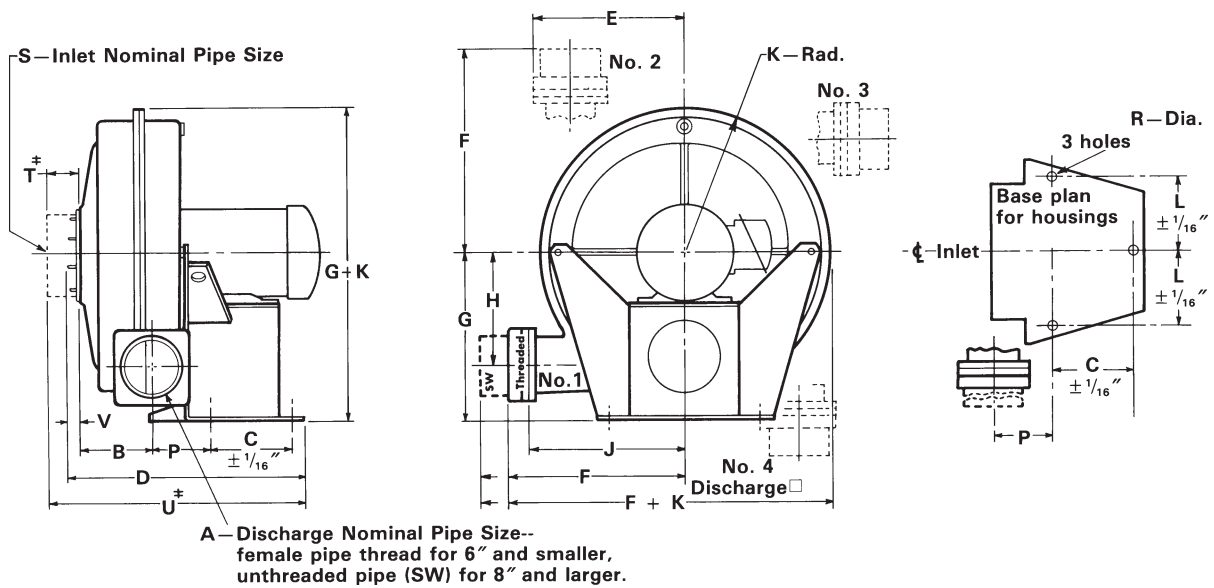

All dimensions are in inches. Dimensions shown apply only to blowers with T-frame motors. Consult North American for dimensions of blowers with other motors.

Blower designation	A	B	C	D	E	F	G	H	J	K	L	P	R	S	T‡	U‡	V	F+K	G+K
2308-17/1__2D	6§	2 ¹ / ₁₆	6	14 ⁵ / ₁₆	12	16 ⁷ / ₈ §	12 ¹ / ₄	8 ¹ / ₄	11 ¹ / ₂	10 ⁹ / ₁₆	5 ¹ / ₂	4	³ / ₄	4	4	17 ¹ / ₂	1 ³ / ₁₆	27 ¹ / ₁₆ §	22 ¹³ / ₁₆
2312-26/1-__7.5D	8†	3 ⁷ / ₈	5 ¹ / ₄	16 ⁹ / ₁₆	15 ¹³ / ₁₆	22 ³ / ₁₆ †	16 ¹ / ₄	11 ³ / ₄	16	14 ³ / ₄	7	5 ⁷ / ₁₆	³ / ₄	6	4	19 ³ / ₈	1 ³ / ₁₆	36 ¹⁵ / ₁₆ †	31
2316-19/1-__5D	6§	3 ¹ / ₄	6 ¹ / ₄	15 ⁷ / ₁₆	13 ¹ / ₂	15 ¹ / ₁₆ §	15	10 ³ / ₄	14	13 ³ / ₄	6 ³ / ₄	4 ³ / ₄	³ / ₄	4	4	18 ⁵ / ₈	1 ³ / ₁₆	28 ⁷ / ₈ §	28 ⁵ / ₁₆

‡ Listed T and U dimensions are for SW inlet. For threaded inlet, T is 1/2".

† SW discharge (unthreaded pipe) is standard and is included in F.

§ Female pipe thread is standard. If SW discharge (unthreaded pipe) is specified, add 3/4" to F.

□ Number 4 discharge position, straight down, can be furnished on special order, a notch having to be cut out of the base at time of assembly.