

Pilot Installation Tips | 4011/4021 Pilot

Cross-connecting a 7350-02-A pilot regulator to the mixture pressure of the 4031 mixer will provide the best ratio control for a 3/4" pilot systems. The gas pressure upstream of the pilot regulator should be set at least 2 osi (3.5"w.c.) higher than the mixture pressure. A common mixture pressure to use is 3-5"w.c. So set the gas pressure upstream of the 7350 to 5-6 osi (9-11"w.c.).

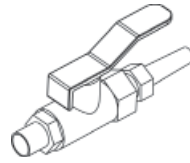

49-04 Petcock is an 1829A-04 lve with 1929-04 hose nipple

Mixture pressure tap (1849-04 Petcock shown open) After set-up is done, pressure tap valves that can release fuel into the room should be removed or plugged.

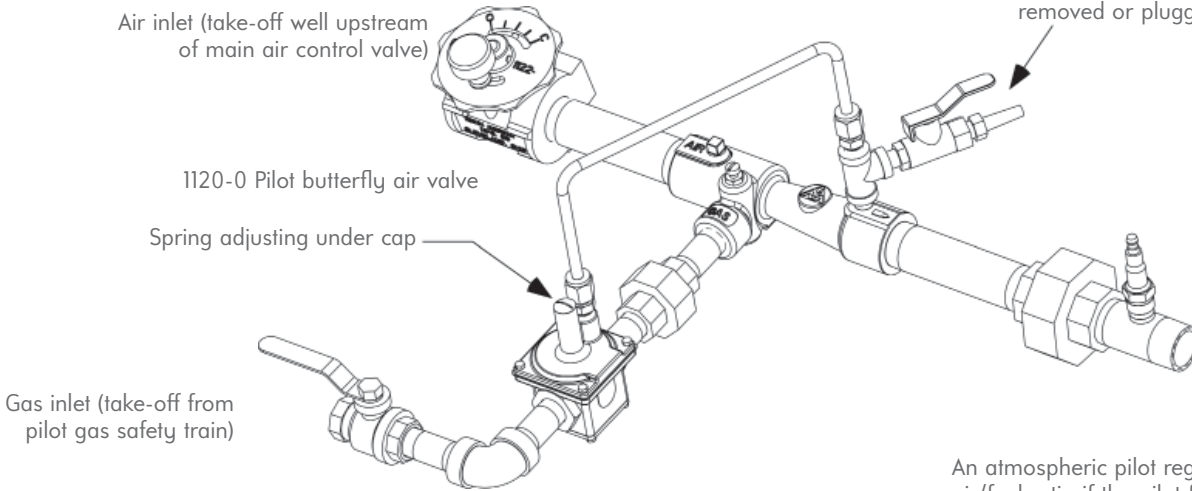

An atmospheric pilot regulator helps maintain proper air/fuel ratio if the pilot flow conditions change. (install close to the mixer)

Cross-connecting a 7350-02-A pilot regulator to the air pressure of the 4031 mixer will provide acceptable ratio control in cases where the fuel cannot be used in the impulse line. A common air pressure to use is 6-8 osi (10.5-14"w.c.), so set the gas pressure to 10-12 osi (17-21"w.c.). For CSI compliant systems set air to 6 osi (10.4"w.c.) and gas pressure of the 7350 to 8 osi (0.5 psi), (13.8"w.c.).

Air pressure tap (1849-04 Petcock shown open valves must be closed without meter attached)

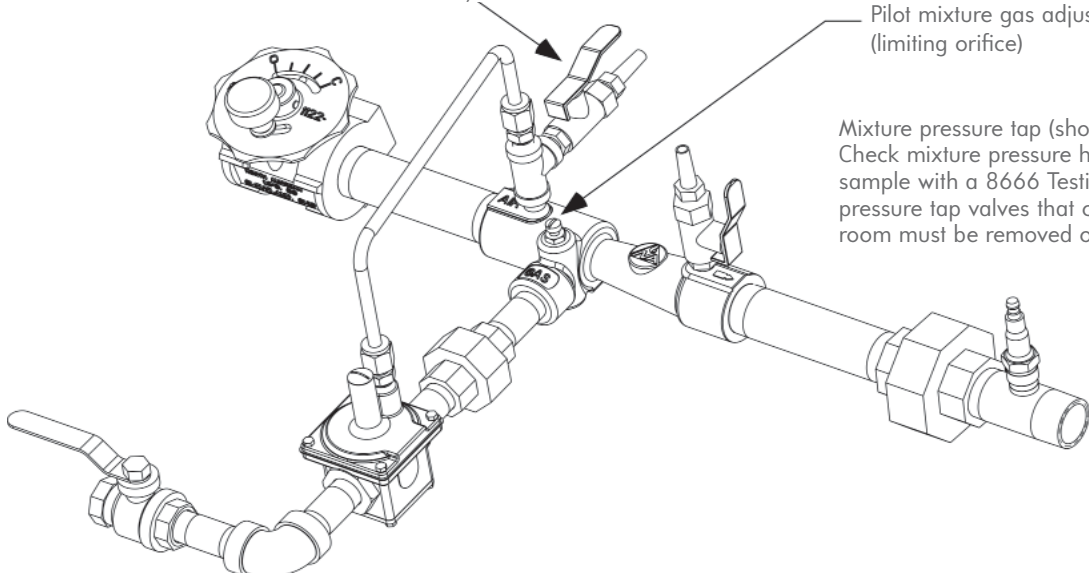

Mixture pressure tap (shown open) Check mixture pressure here or take premix sample with a 8666 Testip. After set-up is done pressure tap valves that can release fuel into the room must be removed or plugged.