

# Set Components | 4011/4021 Pilot

## 4021 PILOT TIPS

Spark Ignited  
(wt. 5.6 oz.)

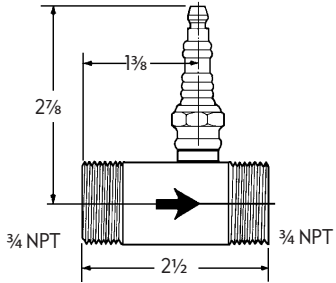

Threaded  
4021-12

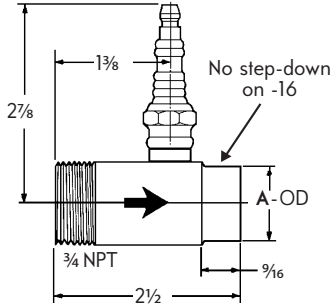

Slip-Fit  
4021-14: "A" = 1"  
4021-16: "A" = 1 1/8"

Manually Lit  
(wt. 3.5 oz.)

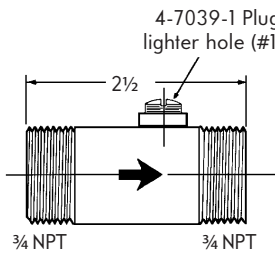

Threaded  
4021-11

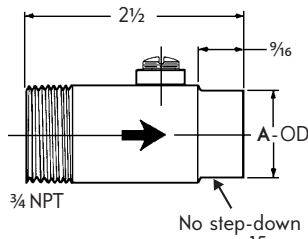

Slip-Fit  
4021-13: "A" = 1"  
4021-15: "A" = 1 1/8"

- All pilot tip inlet threads are 3/4" NPT, as are discharges of 4021-11 and -12.
- 4021-13 and -14 have 1" Ø slip fit and 4021-15 and -16 have 1 1/8" Ø slip fit
- Spark ignited and manual lit tips can be converted to the other by changing plugs.
- The spark plug ships with a 0.034 Inch gap, in some cases a slightly larger gap (0.05) is more reliable.
- The maximum gap is about 0.090" (electrode at 45° angle).

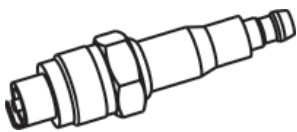

Spark plug  
Part number R240-2465  
(included with -12, -14, -16)



Lighter hole plug  
Part number 4-7039-1  
(included with -11, -13, -15)

## 4031 PILOT MIXER (wt. 27 oz.)

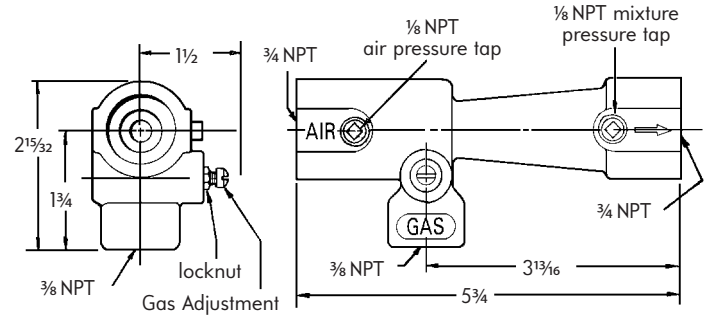

The 4031 Mixer's built-in gas adjustment is a precision needle valve, providing 14 full turns from closed to open. It sets desired gas flow at pressures between zero and 24 osi (42" w.c.).

The inlet air tap or the air/fuel mixture pressure tap on the 4031 mixer should be cross connected to the pilot gas regulator so that the pilot's air/fuel ratio will not be affected by changes in back pressure at the pilot tip. The inlet pressure to the pilot gas regulator should be at least 2 osi (3.5" w.c.) greater than the connected pilot air or mixture pressure.

## VALVES

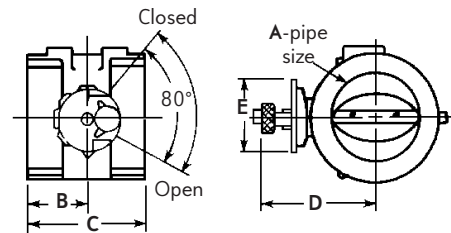

The 1122-0 Air Butterfly Valve sets pilot firing rate with a knurled knob locking device that prevents accidental changing of valve setting. The knurled knob can be set by hand or it can be replaced with a socket head cap screw (provided in the knob) to secure the valve position setting and discourage tampering.

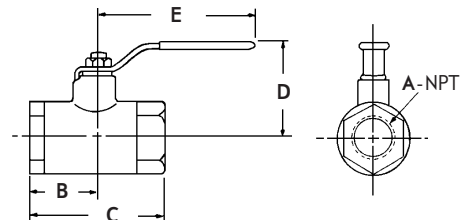

The 1821B-02 Ball Valve is a manual gas shut-off valve

Table 2

Valve	dimensions in inches					wt, lb
	A	B	C	D	E	
1122-0 (air)	3/4	1 3/16	2 3/8	2 3/4	3	2
1821B-02 (gas)	3/8	1 5/16	1 27/32	1 13/32	2 31/32	0.5